

OWNER'S INSTRUCTIONS

If it's not ZillaGreen™, it's not Flexzilla®



Part No.: L1388LFZ

Flexzilla® 20V Cordless Grease Gun Kit



RAPID RELOAD PROCEDURE

IMPORTANT - Follow each step in sequence to ensure proper loading of grease



1. Apply pressure to barrel pushing slightly into head.

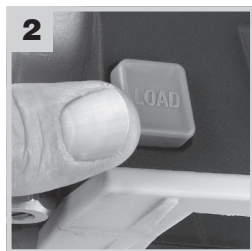

2. Press LOAD button to release barrel.

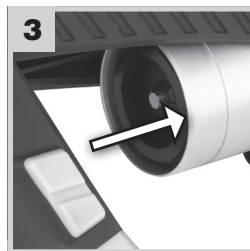

3. Slide barrel out to reload.



4. Press LOAD button and slide barrel back into head.

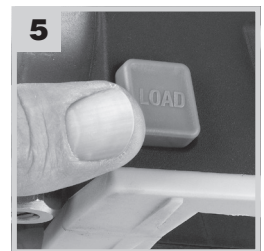

5. Release LOAD button.

AUTOMATIC BLEEDER VALVE: (see figure 1):

- Bleeds air when reconnecting the barrel and head.
- Reduces air locks & priming problems.

SHOULDER STRAP (see figure 2):

Attach strap by latching each end into the hole located on the head casting and hanger at the back of the handle.

HOSE DOCK (see figure 3):

Insert the grease coupler end of the grease hose into the loop hole located on the side of the housing when gun is not in use.

PRESSURE RELIEF VALVE (see figure 4):

CAUTION: Never allow any part of the human body to come in front of, or in direct contact with a grease discharge outlet. Direct the air pocket valve away from yourself and other persons in the vicinity. Never point the nozzle of the gun at yourself or toward anyone else. Pressure relief is factory preset at 7000 psi +/- 500 psi. If back pressure in the grease line exceeds the preset limit, grease will then be expelled from this valve to reduce risk of motor overload and limit excessive grease pressure in grease hose. Do not exceed specifications or alter gun to perform beyond ratings. Such misuse will void the warranty and can cause possible injury.

WARNING: Do not adjust or remove pressure relief valve.

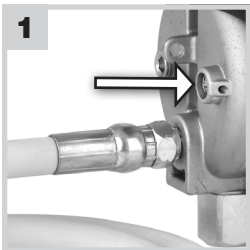

1. Automatic Air Bleeder



2. Shoulder Strap

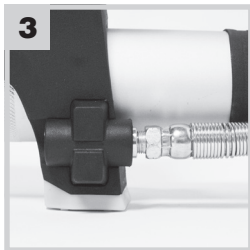

3. Hose Dock

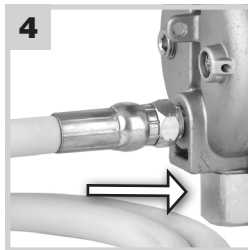

4. Pressure Relief Valve

ASSEMBLY

BULK LOADING:

- Remove grease barrel from pump head assembly.
- Insert the open end of the grease barrel into lubricant in bulk container. Slowly pull the follower handle back while pushing the grease barrel deeper into the lubricant to prevent air pockets from being pulled into the grease barrel assembly.
- When the follower rod is fully extended, pull it sideways to latch the rod notch into the slot in the grease barrel end cap.
- Assemble the grease barrel into the pump head. Release the follower rod from slot. Push the follower rod into the grease barrel.
- Follow priming instructions below.

FILLER PUMP LOADING (Using Optional Filler Nipple: Part #L2461 - Not Included):

- Replace the plug in the head of the grease gun with a 1/8" MNPT filler nipple for loading with a manually-operated grease transfer pump. Follow filler pump instructions also.
- Insert the gun filler nipple into the filler pump socket.
- Operate the filler pump to fill the grease barrel. When the follower rod can be pulled out without effort and the rod notch is exposed, the grease barrel is filled. The follower rod will be extended approximately 8" (20.3 cm)
- Push the follower rod into the grease barrel assembly.
- Follow priming instructions below.

Flexzilla is a registered trademark of Weems Industries, Inc. US Pat. No. 8,297,476 CA Pat. No. 2,743,126
The color CHARTREUSE as applied to the body of the grease gun and grease hose is a trademark of Weems Industries, Inc.

Legacy Manufacturing Company
Marion, IA 52302 USA

Ph: 319.373.7305

service@legacymfg.com
legacymfg.com

INS1388LFZ
(Published 04/10/19 Revised 02/15/22)

ASSEMBLY (CONT.)

PRIMING:

- Release follower rod and push rod up
- Press Automatic Bleeder Valve to expel air
- Pull trigger until grease flows without air

OPERATION

- **DANGER:** Never operate product in an explosive atmosphere. Electric power tools and battery powered tools can create sparks, which may ignite flammable liquids, dusts, or fumes.
- **DANGER:** Because of the high working pressures developed by this gun, the possibility of grease injection into the flesh, or an eye, is a potential hazard. Never allow any part of the human body to come in front of, or in direct contact with a grease discharge outlet or potential hose rupture. Never point the nozzle of the gun at yourself or toward anyone else. If accidental grease injection should occur, seek Immediate Emergency Medical Attention. DO NOT try to treat the injury yourself! If injection occurs, provide grease product information to medical personnel. Be certain that any and all system components will withstand the pressures being developed. Never exceed the pressure rating of any component in the system. Inspect all hoses and fittings before each use. Weak, worn, or damaged hoses are a hazard. Do not use any defective, unmarked, or damaged hoses. Do not repair the grease whip hose. Replace if damaged.
- **WARNING:** Grease gun can develop high pressure – up to 7000 psi (483 bar). Use safety glasses and gloves for protection during operation. Keep hands clear of the exposed rubber or plastic portion of hose. Extreme pressure may cause nozzle extension or grease hose to burst.
- **CAUTION:** Inspect and tighten all fluid connections regularly and replace weak or damaged hoses or other components with suitable replacements that will withstand the pressures developed.
- **CAUTION:** Release trigger if blocked line causes grease gun to stall. Continued operation could damage the motor.

CHARGER OPERATION:

The battery pack is not fully charged out of the carton. Read and understand all of the safety instructions, and then follow the battery charging instructions that follow.

- Make sure power cord circuit voltage is the same as that shown on the charger. Connect charger to the power source.
- Place small plug on the end of the charger cord into the plug hole on the back of the battery. Do not force. When proper connection is made, the red light will glow, indicating the charger has switched to quick-charge mode.
- Charge the battery for one full hour including quick-charge time prior to initial use.
- When the battery pack is fully charged, the red light will go out and the green light will glow. The battery pack will continue to receive a trickle charge. Remove the battery pack from the charger.
- Disconnect charger power cord from the power source when not charging battery pack.
- Important: Battery pack temperature will increase during and shortly after use. The battery pack may not accept a full charge if charged immediately after use. For best results, allow the battery pack to cool to room temperature before charging.

GREASE GUN OPERATION:

- Insert fully-charged battery pack into the end of the grease gun handle by aligning the slots in the handle with the matching boss on the battery pack. Do not force objects. Make certain battery pack is fully engaged into handle cavity and snaps into place at battery pack latch button. Depress tool switch momentarily to check battery pack connection to tool. To release battery from tool handle, depress battery pack latch button until battery releases and can be withdrawn from cavity in tool handle. Do not allow metal objects to contact battery pack terminals while battery is not in charger or tool.
- Re-Priming: Follow procedure for cartridge loading (see "Assembly" section), but do not reload. This procedure will allow the gun to reprime using the automatic bleeder valve. If necessary, repeat the process until all trapped air pockets have been purged from the grease barrel.
- Connect grease coupler to standard grease zerk fitting on equipment or machinery to be greased. Release trigger to stop grease flow. To disconnect grease coupler from zerk, angle the coupler and use a twisting motion. If the coupler will not disengage, the tip sleeve of the coupler can be loosened with tools to allow adjustment in the tension of the coupler gripping the grease zerk fitting. Retighten the coupler sleeve to prevent coupler leaking.
- Operate the trigger to dispense grease. The trigger must be continuously depressed to dispense grease. If back pressure in the grease line exceeds the 7000 psi limit, grease will then be expelled from the pressure relief valve to limit the pressure in order to reduce risk of motor overload and limit excessive grease pressure in grease hose. Do not exceed specifications or alter gun to perform beyond ratings. Such misuse will void the warranty and can result in possible injury.

MAINTENANCE

- **WARNING:** To reduce the risk of personal injury, always unplug the charger and remove the battery pack from the charger or tool before performing any maintenance. Never disassemble the tool, battery pack, or charger. Refer to an authorized service facility for all repairs.
- **WARNING:** To reduce the risk of personal injury and damage, never immerse your tool, battery pack, or charger in liquid or allow a liquid to flow inside them or be splashed on them.

MAINTAINING TOOL:

- a. If the tool does not start or operate at full power with a fully charged battery pack, clean the contacts on the battery pack. If the tool still does not work properly, contact an authorized service facility for assistance.
- b. Clean excessive grease buildup from tool exterior. To reduce the risk of injury and damage, wipe grease from tool exterior surfaces. It may become difficult to operate the tool and handle in a safe manner if tool surfaces become grease covered. Disconnect charger from power source and allow to cool before cleaning. Wipe surfaces with dry towel to remove grease. Do not use water or any cleaning solvents on tool, charger or battery pack.
- c. Inspect grease hose for damage, excessive bending, cracks, and cuts. Do not use damaged or worn hoses. Replace worn or damaged hoses immediately. Use only replacement hoses that are marked and designed for the pressures this tool can develop. Do not use any defective, unmarked, or damaged hoses. Do not repair the grease hose. Replace if damaged.
- d. Replace worn or damaged grease fittings. Replacement fittings must be capable of withstanding the pressures developed.

REPLACEMENT PARTS AND ACCESSORIES

- Flexzilla Replacement 42in. Grease Hose..... L2930FZSP
- 20V DC Lithium-Ion Battery PackL1388LFZ-B
- 1-Hour Quick ChargerL1388LFZ-C
- Barrel Push Button Kit.....RP009008L
- Optional Universal Filler Nipple (for use with manual grease transfer pumps)L2461
- Optional grease cartridge storage box.....GCB12 (Rigid polypropylene container for storing and transporting twelve standard 14 oz grease cartridges, shoulder strap included)

WARNINGS / TIPS / WARRANTY

GENERAL SAFETY RULES - FOR ALL BATTERY OPERATED TOOLS

WARNING! READ AND UNDERSTAND ALL INSTRUCTIONS.

Failure to follow all instructions listed below may result in electric shock, fire, and / or serious personal injury.

WORK AREA

- Keep your work area clean and well lit. Cluttered benches and dark areas invite accidents.
- Do not operate power tools in explosive atmospheres, such as in the presence of flammable liquids, gases, or dust. Power tools create sparks which may ignite the dust or fumes.
- Keep bystanders, children, and visitors away while operating a power tool. Distractions can cause you to lose control.

ELECTRICAL SAFETY

- Do not abuse the cord. Never use the cord to carry the tool. Keep cord away from heat, oil, sharp edges or moving parts. Replace damaged cords immediately. Damaged cords may create a fire.
- A battery operated tool with integral batteries or a separate battery pack must be recharged only with the specified charger for the battery. A charger that may be suitable for one type of battery may create a risk of fire when used with another battery.
- Use battery operated tool only with specifically designated battery pack. Use of any other batteries may create a risk of fire.

WARNINGS / TIPS / WARRANTY (CONT.)

PERSONAL SAFETY

- Stay alert, watch what you are doing and use common sense when operating a power tool. Do not use tool while tired or under the influence of drugs, alcohol, or medication. A moment of inattention while operating power tools may result in serious personal injury.
- Dress properly. Do not wear loose clothing or jewelry. Contain long hair. Keep your hair, clothing, and gloves away from moving parts. Loose clothes, jewelry, or long hair can be caught in moving parts.
- Avoid accidental starting. Be sure switch is in the locked or off position before inserting battery pack. Carrying tools with your finger on the switch or inserting the battery pack into a tool with the switch on invites accidents.

TOOL USE AND CARE

- Use clamps or other practical way to secure and support the work piece to a stable platform. Holding the work by hand or against your body is unstable and may lead to loss of control.
- Do not force tool. Use the correct tool for your application. The correct tool will do the job better and safer at the rate for which it is designed.
- Do not use the tool if switch does not turn it on or off. A tool that cannot be controlled with the switch is dangerous and must be repaired.
- Disconnect battery pack from tool or place the switch in the locked or off position before making any adjustments, changing accessories, or storing the tool. Such preventive safety measures reduce the risk of starting the tool accidentally.
- Store idle tools out of reach of children and other untrained persons. Tools are dangerous in the hands of untrained users.

SERVICE

- Tool service must be performed only by qualified repair personnel. Service or maintenance performed by unqualified personnel may result in a risk of injury.

SPECIFIC SAFETY RULES

- **DANGER:** Because of the high working pressures developed by this gun, the possibility of grease injection into the flesh, or an eye, is a potential hazard. Never allow any part of the human body to come in front of, or in direct contact with a grease discharge outlet or potential hose rupture. Never point the nozzle of the gun at yourself or toward anyone else. If accidental grease injection should occur, seek Immediate Emergency Medical Attention. DO NOT try to treat the injury yourself! If injection occurs, provide grease product information to medical personnel. Be certain that any and all system components will withstand the pressures being developed. Never exceed the pressure rating of any component in the system. Inspect all hoses and fittings before each use. Weak, worn, or damaged hoses are a hazard.
- **WARNING:** Before each use, inspect hoses for signs of wear, leaks, or loose fittings. Inspect and tighten all fluid connections regularly and replace weak or damaged hose. Do not use any defective, unmarked, or damaged hoses. Do not repair the grease whip hose. Replace if damaged. Most injections occur because of component rupture. Any cuts or sharp bends in hose can rupture and cause personal injury. Use only components that will withstand the pressures being developed.

ADDITIONAL SAFETY RULES FOR BATTERY PACK AND CHARGER

THE BATTERY PACK IS NOT FULLY CHARGED OUT OF THE CARTON. READ AND UNDERSTAND ALL OF THE SAFETY INSTRUCTIONS BELOW.

IMPORTANT SAFETY INSTRUCTIONS FOR BATTERY PACK:

- Do not incinerate the battery pack even if it is severely damaged or is completely worn out. The battery pack can explode in a fire.
- A small leakage of liquid from the battery pack cells may occur under extreme usage or temperature conditions. If this leakage gets on your skin:
 - a. Wash quickly with soap and water.
 - b. Neutralize with a mild acid such as lemon juice or vinegar.
 - c. If battery liquid gets into your eyes, flush them with clean water for a minimum of 15 minutes and seek immediate medical attention. *Medical note:* The battery cells are rechargeable lithium-ion type.
- A battery operated tool with integral batteries or a separate battery pack must be recharged only with the specified charger for the battery. A charger that may be suitable for one type of battery may create a risk of fire when used with another battery.
- Use battery operated tool only with specifically designated battery pack. Use of any other batteries may create a risk of fire. DO NOT substitute or modify another battery to use with your grease gun. When ordering replacement battery packs, be sure to indicate the specific part number for your tool.
- Disconnect battery pack from tool or place the switch in the locked or off position before making any adjustments, changing accessories, or storing the tool. Such preventive safety measures reduce the risk of starting the tool accidentally.
- When battery pack is not in use, keep it away from other metal objects like: paper clips, coins, keys, nails, screws, or other small metal objects that can make a connection from one terminal to another. Shorting the battery terminals together may cause sparks, burns, or a fire.

IMPORTANT SAFETY INSTRUCTIONS FOR CHARGER:

- **DANGER:** Electrocutation hazard! 120 volts are present at charger cord terminals. Do not probe with conductive objects. Electric shock or electrocution may result.
- **WARNING:** Shock hazard. Do not allow any liquid to get inside charger. Electric shock may result.
- **CAUTION:** Burn hazard. To reduce the risk of injury, charge only Flexzilla 20V battery packs that fit the charger included with this tool. Do not attempt to charge any other battery types with this charger. Other types of batteries may burst causing personal injury and damage.
- **CAUTION:** Charger is intended for use indoors only. Do not expose charger to rain, snow, or frost. Do not place charger on any wet surfaces. Do not place charger in any location where water may drip or splash on the charger or on the surface where the charger rests.

MINIMUM RECOMMENDED WIRE SIZE FOR EXTENSION CORDS

For Total Length of Cord: 25 ft. (7.6m) to 50 ft (15.2 m)use 18 gauge minimum cord size.
75 ft. (22.9 m) to 100 ft (30.5 m)use 16 gauge minimum cord size.
125 ft. (38.1 m) to 150 ft (45.7 m)use 14 gauge minimum cord size.
175 ft. (53.3 m)use 12 gauge minimum cord size.

- Remove adjusting keys or wrenches before turning the tool on. A wrench or a key that is left attached to a rotating part of the tool may result in personal injury.
- Do not overreach. Keep proper footing and balance at all times. Proper footing and balance enables better control of the tool in unexpected situations.
- Use safety equipment. Always wear eye protection. Dust mask, non-skid safety shoes, hard hat, or hearing protection must be used for appropriate conditions.

- When battery pack is not in use, keep it away from other metal objects like: paper clips, coins, keys, nails, screws, or other small metal objects that can make a connection from one terminal to another. Shorting the battery terminals together may cause sparks, burns, or a fire.
- Maintain tools with care. Keep cutting tools sharp and clean. Properly maintained tools with sharp cutting edge are less likely to bind and are easier to control.
- Check for misalignment or binding of moving parts, breakage of parts, and any other condition that may affect the tool's operation. If damaged, have the tool serviced before using. Many accidents are caused by poorly maintained tools.
- Use only accessories that are recommended by the manufacturer for your model. Accessories that may be suitable for one tool may create a risk of injury when used on another tool.

- When servicing a tool, use only identical replacement parts. Follow instructions in the Maintenance section of this manual. Use of unauthorized parts or failure to follow Maintenance Instructions may create a risk of shock or injury.

- **WARNING:** Do not adjust pressure relief valve.
- **WARNING:** Wear safety goggles or other eye protection. The grease gun can develop high pressure – up to 7000 psi (483 bar). Use safety glasses and gloves for protection during operation. Grease leaks under pressure can penetrate the eyes and skin. Keep grease products away from eyes. Consult grease product labeling for safety precautions.
- **CAUTION:** Keep hands and fingers clear of the exposed rubber or plastic portion of hose. Extreme pressure may cause nozzle extension or hose to burst.
- **CAUTION:** Wipe up any dripped or spilled grease residue and keep work area clean. Grease on floor surfaces can be slippery and cause loss of footing and possible injury.

- Charge battery pack with charger made for this specific tool model.
- Do not splash battery pack or charger with water or other liquids. Do not use or attempt to charge any battery pack that has become wet or that has had water splashed or dripped on to it.
- Do not store or use the tool and / or battery pack in locations where the temperature may reach 105° F (such as outside sheds or metal buildings in summer).
- **DANGER:** Electrocutation hazard! Never attempt to open the battery pack for any reason. If battery pack case is cracked or damaged, do not insert into charger. Electric shock or electrocution may result. Damaged battery packs should be taken to a battery service center for recycling.
- **WARNING:** Fire hazard. Do not store or carry battery packs so that metal objects can contact exposed battery terminals. Do not place battery pack in aprons, pockets, tool boxes, product kit boxes, drawers, etc., along with other metal objects. Battery pack terminals could be short-circuited possibly causing severe burns or fire, as well as causing damage to the battery pack.
- **WARNING:** Do not transport batteries unless exposed battery contacts are protected and insulated from materials that could contact them and cause a short circuit.
- **CAUTION:** Battery pack must be securely attached to tool. If battery pack is not attached securely, personal injury may result.
- **IMPORTANT:** Dispose of expended or damaged battery packs properly by returning to a local battery service dealer or contact your local recycling agencies for proper disposal information. Under various state and local laws it may be illegal to dispose of this battery into the municipal waste stream.

- Pull the plug rather than the cord to remove from power supply connection. This reduces the risk of damage to the plug and cord. Do not use charger or plug charger cord if cord or plug is damaged. Have damaged cord, plug, or strain reliever replaced immediately. Do not attempt to repair power cord or plug.
- Make sure cord is located so that it will not be stepped on, tripped over, or otherwise subjected to stress or damage.
- Do not use extension cord unless it is absolutely necessary. Use of improper extension cord could result in risk of fire, electric shock, or electrocution. If an extension cord must be used, make sure the extension cord is properly wired and in good electrical condition. The extension cord must have adequate wire size (AWG or American Wire Gauge) for safety. The smaller the gauge number of the wire, the greater the capacity of the cable. For example, a 16 gauge has more capacity than 18 gauge cord.

- The charger is designed to operate on standard 120V AC electrical power. Do not attempt to use it on any other voltage.
- Do not operate the charger if it has received a sharp blow, been dropped, or otherwise damaged in any way. Replace the charger or take it to an authorized service center.

WARNINGS / TIPS / WARRANTY (CONT.)

SYMBOLS

DC	direct current	AC	alternating current
—	direct current symbol	UL	Underwriter's Laboratories listing on charger
V	volts	+	Positive terminal on battery pack and charger
Hz	hertz	-	Negative terminal on battery pack and charger
psi	pounds per square inch (units of pressure)	UL745-3	UL Standard for Safety for Battery-Operated Tools

SPECIFICATIONS

- Model: L1388LFZ 20V DC Cordless Grease Gun
- Grease Reservoir Capacity: 14.5 oz. cartridge or 16 oz. bulk
- Lubricant (grease): Up to NLGI #2
- Battery Quick Charge: 1 hour charger
- Maximum Operating Pressure: Intermittent pressure: 7000 psi
- Battery Voltage: 20v max / 18v nominal
- Battery Capacity: 1500 milliamp hours
- Input Power Source: 120V AC

FUNCTIONAL DESCRIPTION

The Flexzilla 20V DC battery-powered, cordless grease gun allows convenient high-pressure greasing at grease pressures up to 7000 psi, utilizing a motor and set of gears to develop pressure for dispensing grease as a single-action, positive displacement pump. The gun is operated (after grease-loading) by squeezing the trigger to dispense grease either freely from the grease nozzle (standard zerk coupler) or by engaging the grease coupler onto standard grease zerk fittings on equipment and machinery for high-pressure greasing. The gun is equipped with a pressure-relief valve to limit grease pressure to 7000 psi to reduce risk of motor overload, tool damage, and to extend battery life. Additionally, an automatic bleeder valve bleeds trapped air in the grease barrel to make priming faster and easier. Do not exceed specifications or alter gun to perform beyond ratings. Such misuse will void the warranty.

WARRANTY*

LEGACY MANUFACTURING COMPANY ("LEGACY") warrants that this equipment will be free from defects in material and workmanship for a period of one (1) year from the date of purchase, under normal use. LEGACY'S sole obligation under this warranty is limited to replacing or repairing, free of charge, any equipment that proves to be defective under normal conditions and use according to the recommendations of LEGACY. To obtain repair or replacement, the equipment must be shipped to a LEGACY authorized Warranty and Service Center during the warranty period, transportation charges prepaid, with proof of date of purchase. In the event of repair or replacement, the warranty period shall not be extended beyond the original warranty period. While necessary maintenance or repairs on your Legacy equipment can be performed by any company, we recommend that you use only authorized Legacy service centers. Improper or incorrectly performed maintenance or repair voids this warranty. Contact us at service@legacymfg.com or www.legacymfg.com/instruction-manuals/ for installation instructions.