



Part No.: L8251FZP

## Retractable Air Hose Reel, 50 ft.



### SAVE THESE INSTRUCTIONS! READ ALL INSTRUCTIONS!

**CAUTION:** Read all instructions and warnings before operating this product.

**CAUTION:** Inspect hose before each use. Do not exceed 150 psi working pressure. Do not kink, twist, knot or abrade hose. Do not wrap hose around body. Keep hose away from hot surfaces and/or chemicals. KEEP CHILDREN AWAY FROM WORK AREA!

### SAFETY INSTRUCTIONS

- Do not allow tools to hang on the end of the hose when not in use.
- Do not allow the hose to contact hot, sharp or heated surfaces that could damage it.
- Always recoil hose back into the reel when work is completed.
- Do not allow hose to retract uncontrolled.

### INSTALLATION AND MOUNTING OPTIONS

Choose fasteners suitable for the mounting surface, the weight of the reel, and the force of pulling the hose. Use a leveling device for proper positioning. Use hex head fasteners up to 5/16" (8 mm) in diameter, with a minimum 1/2" (12.5 mm) hex head. Mounting fasteners not included. See mounting diagram on last page.

#### Wall Mounting Option:

Recommended height is 5 ft. (1.5 m) to 8 ft. (2.5 m)

#### Ceiling Mounting Option:

Recommended ceiling height is 8 ft. (2.5 m) to 10 ft. (3 m)

#### Installation:

1. Locate 3 holes on mounting bracket
2. Observe both sides of reel housing and remove screws that hold bracket pivots in reel. Remove pivots and bracket from reel.
3. Mount bracket to surface.
4. Re-install reel to bracket with the pivots. Re-install screws.

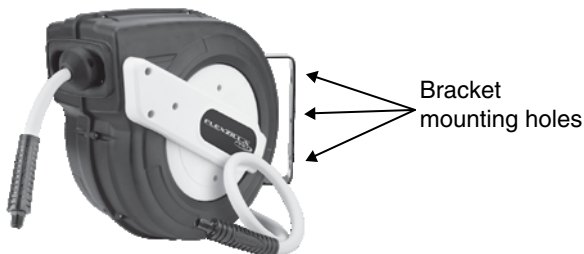

### OPERATION

The reel can lock the air hose at approximately 17-inch intervals. Each latching interval is announced by a series of five "clicks." This "ratcheting" sound lets you know that the reel is in the latching zone as the air hose is pulled out.

#### 1. Latching Hose -

After pulling out the desired length of hose, allow it to retract slightly until you feel it stop. The reel is now latched.

#### 2. Rewinding Hose -

Pull out approximately one extra foot from latch position and allow hose to retract. The reel will continue rewinding until hose is fully retracted. Do not allow the hose to rewind uncontrolled back into the reel. Personal injury can result.

#### 3. Hose Stopper Adjustment -

To modify the hose stopper position, pull out hose to the desired length and latch reel. Loosen screws holding the two halves of the hose stopper together, slide stopper to opening of reel and tighten screws.

**NOTE: ENSURE THE REEL IS COMPLETELY LATCHED BEFORE LOOSENING THE HOSE STOPPER.**

4. Do not extend hose beyond the indicator shown in the image below.



Red label indicator located at end of hose

## REPAIR INSTRUCTIONS

### Replacing Extension Hose (part 1):

1. Pull on extension hose to complete extension
2. Slowly allow reel to retract hose back into reel approximately 1/2 of a full rotation
3. Pull on extension hose slowly until reel is in a latched position
4. Remove:
  1. 3 screws
  2. belt cover
  3. gear cover
  4. belt
  5. small gear

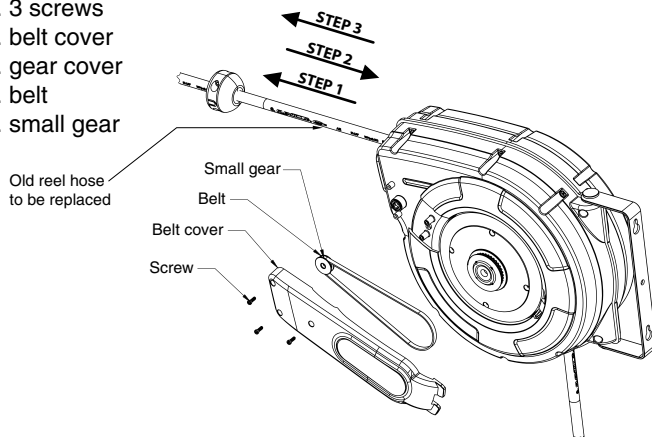

### Replacing Extension Hose (part 2):

1. Remove:
  1. 4 screws
  2. swivel cover

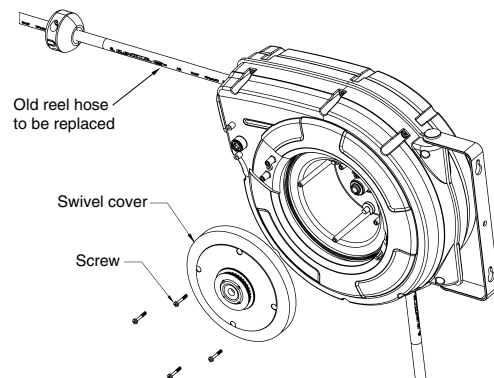

### Replacing Extension Hose (part 3):

1. Remove C-Clip
2. Washer
3. Swivel body, with hose, hose clamp and bend restrictor

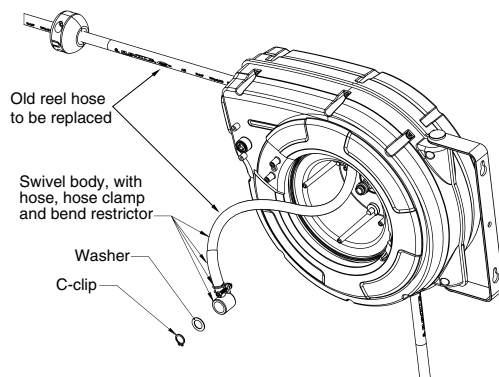

### Replacing Extension Hose (part 4):

1. Slide bend restrictor away from hose clamp
2. Loosen hose clamp and slide away from swivel
3. Remove hose from swivel
4. Remove hose from reel

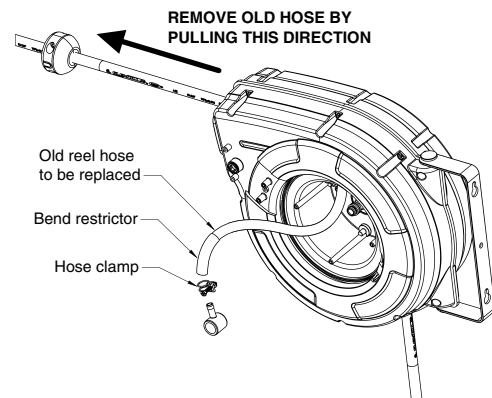

### Replacing Extension Hose (part 5):

1. Install replacement reel hose RP005051-FZ

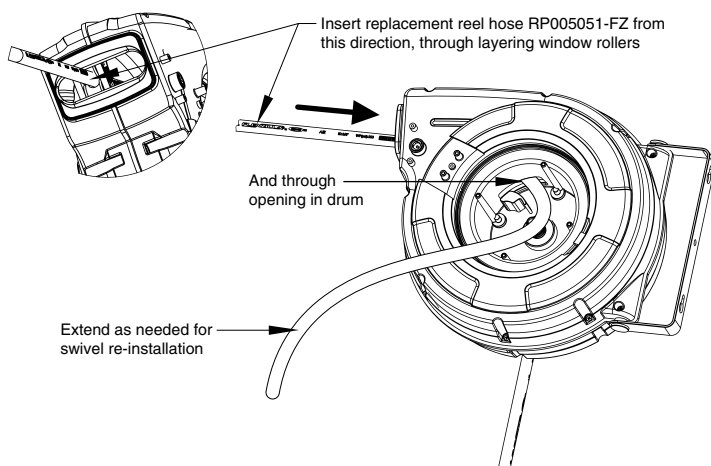

### Replacing Extension Hose (part 6):

1. Slide bend restrictor on hose
2. Slide clamp on hose
3. Insert swivel into hose

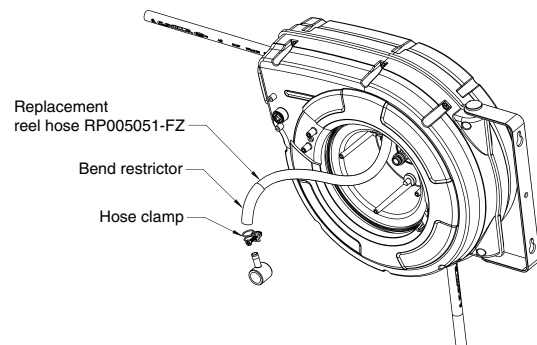

## REPAIR INSTRUCTIONS (CONT.)

### Replacing Extension Hose (part 7):

1. Pull on reel hose RP005051-FZ
2. Guide swivel toward axle shaft
3. Slip swivel onto axle shaft
4. Install washer
5. Install c-clip

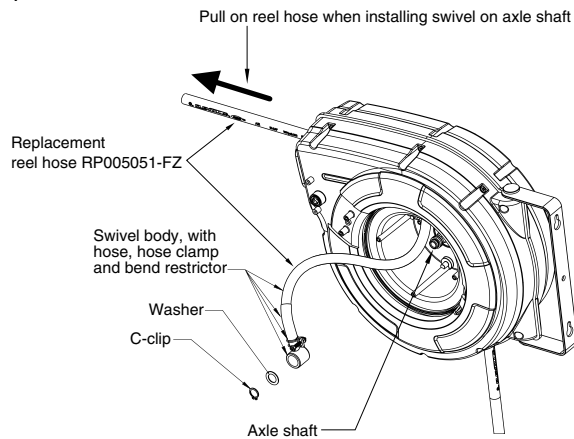

### Replacing Extension Hose (part 8):

1. Install swivel cover
2. Align tab on cover to slot on drum (see DETAIL C)
3. Install all 4 screws

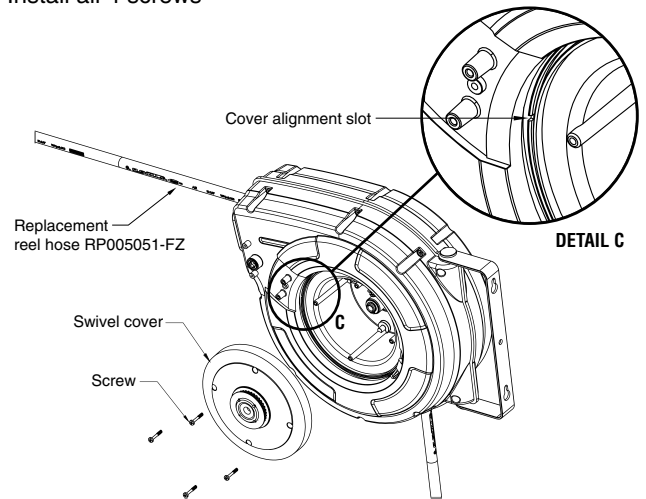

### Replacing Extension Hose (part 9):

Before releasing reel lock to retract new hose into reel:

1. Remove hose stopper from old hose
2. Re-install hose stopper on new hose
3. Position stopper approximately 2 ft. from end of hose
4. Re-install the small gear (see DETAIL A)
5. Rotate gear clockwise ONLY!
6. Rotate until the layering window's right edge is aligned with left side of housing mid section rib (see DETAIL B)

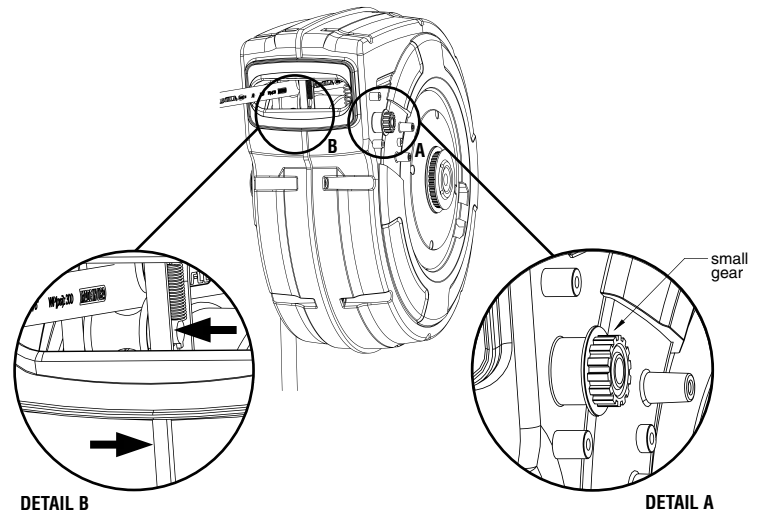

### Replacing Extension Hose (part 10):

1. Install belt
2. Install gear cover
3. Install belt cover
4. Install all 3 screws
5. Pull on reel hose RP005051-FZ to release from latch
6. Slowly allow reel spring to retract reel hose into reel

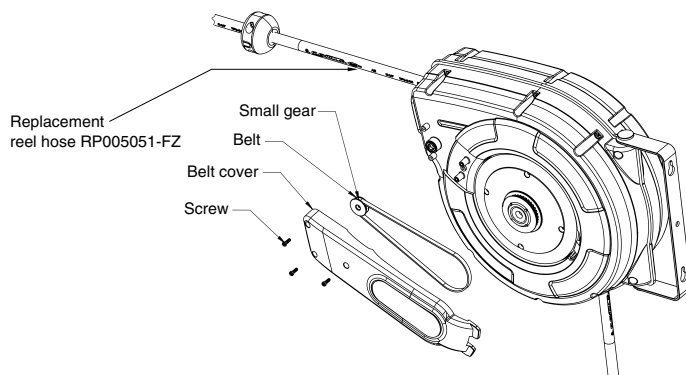

SEE INSTRUCTIONS FOR IMPORTANT MOUNTING INFORMATION

REPAIR INSTRUCTIONS

Replacing Lead-in Hose:

- 1. Remove the 4 screws
- 2. Remove cover
- 3. Lift locking finger on fitting
- 4. Rotate counter clockwise
- 5. Pull fitting out of the reel
- 6. Replace with new L8251FZLI

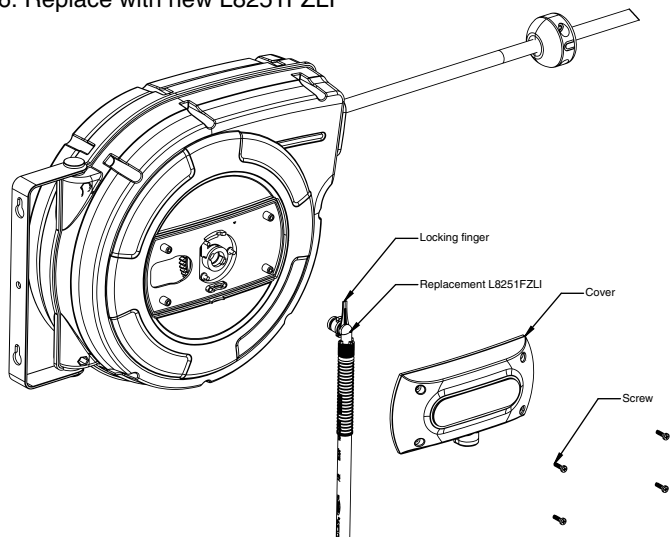

REPLACEMENT PARTS	
Part #	Description
L8251FZLI	Lead-in air hose 3/8in. x 5ft.
RP005051-FZ	Replacement air hose 3/8in. x 50ft.
RP018251	Hose stopper

5 YEAR LIMITED WARRANTY  
For warranty information visit [flexzilla.com/warranty](http://flexzilla.com/warranty)  
or call 800-645-8258

